

INSTRUKCJA MONTAŻU

FURTKA OGRODZENIOWA
SZAFIR M

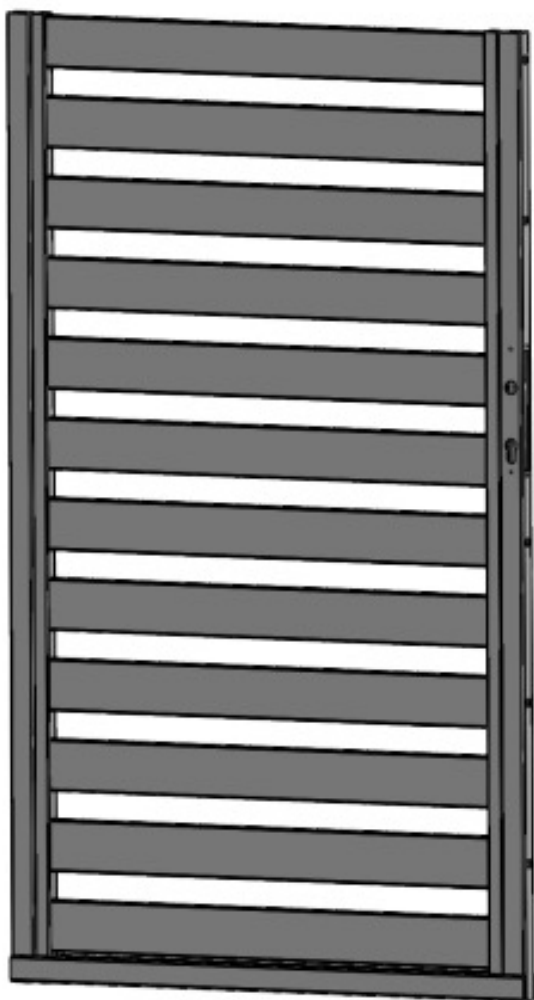

ZAWARTOŚĆ OPAKOWAŃ

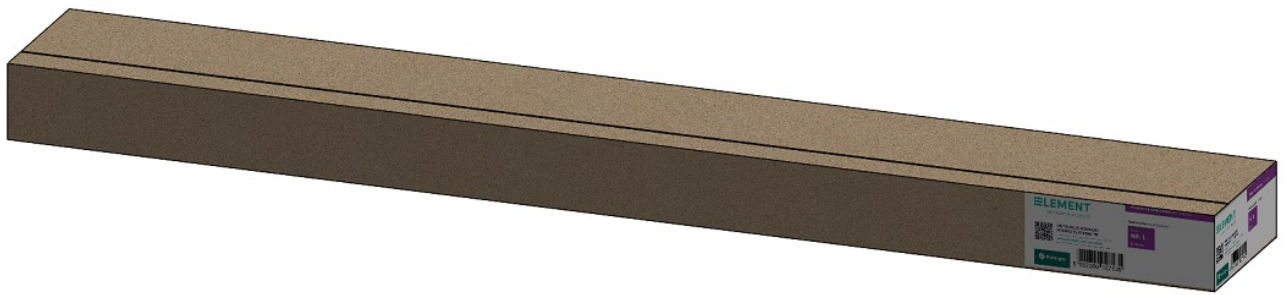

6x  80x20



6x  80x20



2x  25x25



1x  40x30



1x  40x30



1x  40x40

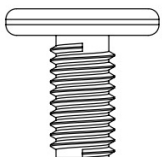

4x M6x12 [A]



12x (M6x25) [B]



12x [C]

2x [D]
40x30



15x [E]



12x [F]



1x [G]

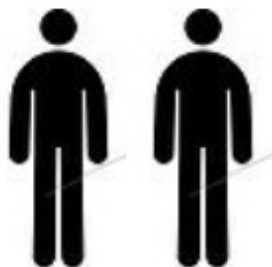

POTRZEBNE NARZĘDZIA

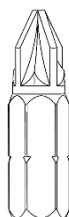
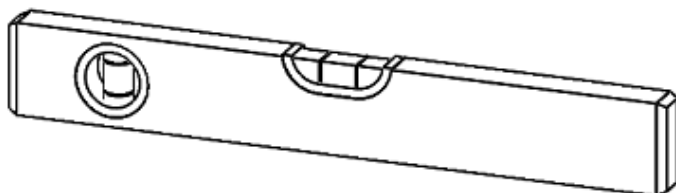
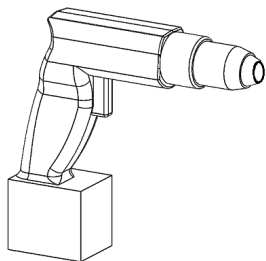
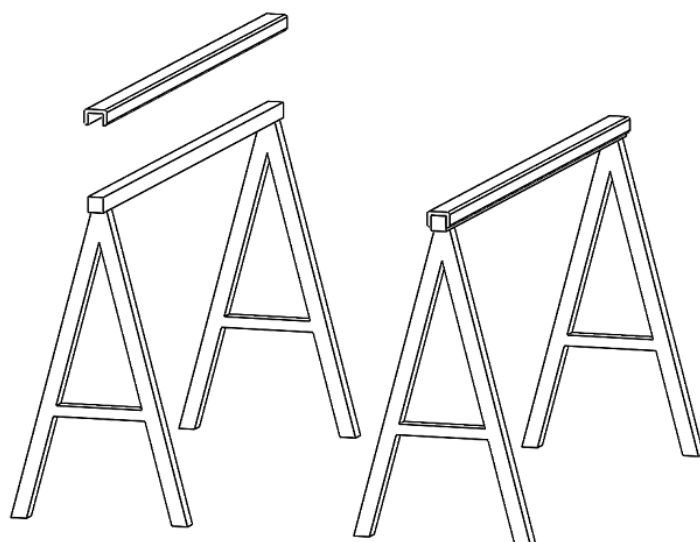

BIT PH 2

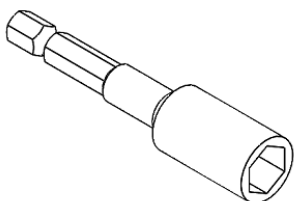

HEX M8

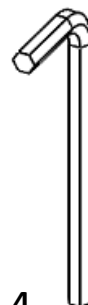

HEX 4

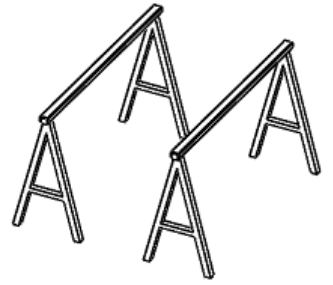
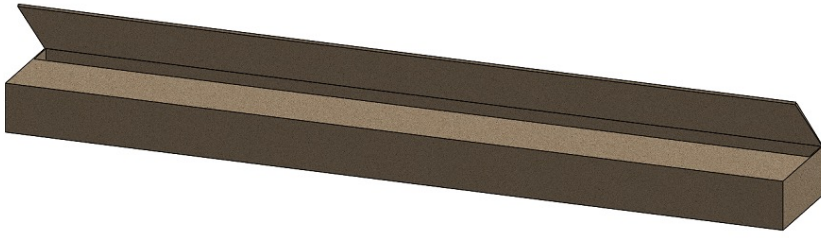

[1]

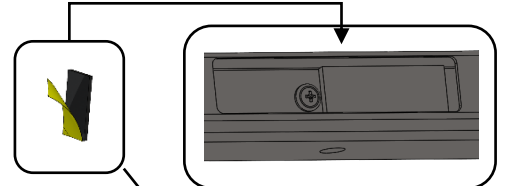

[2]

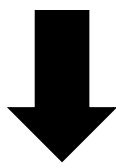
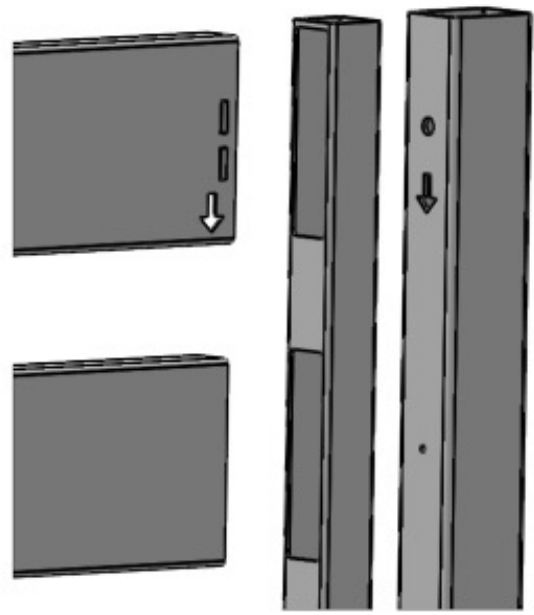

[B]

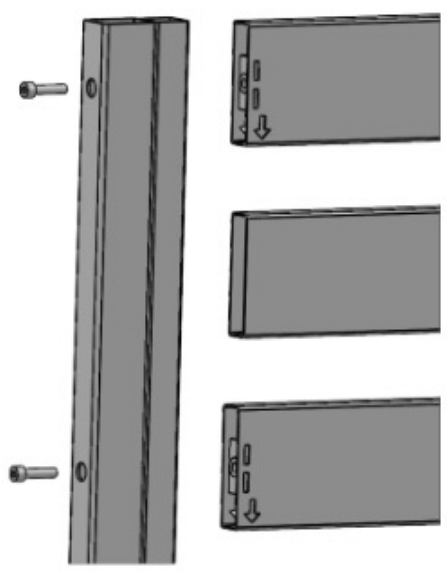

[3]

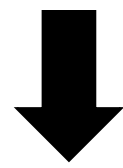
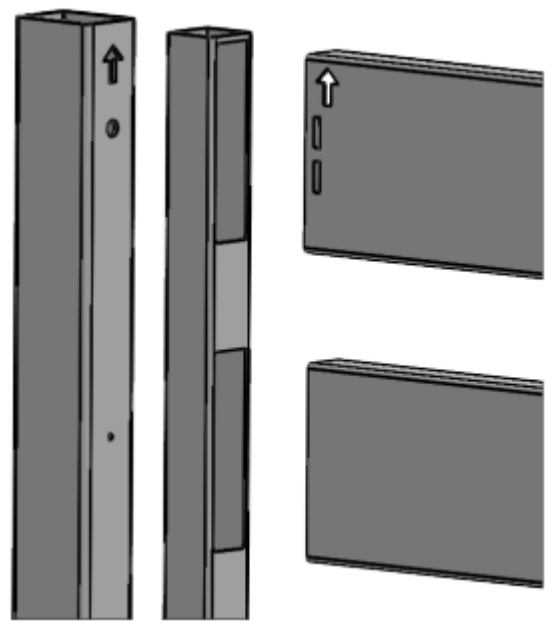

[B]

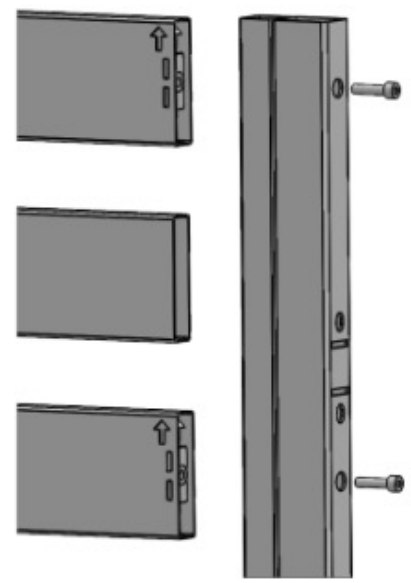

[4]

[A]

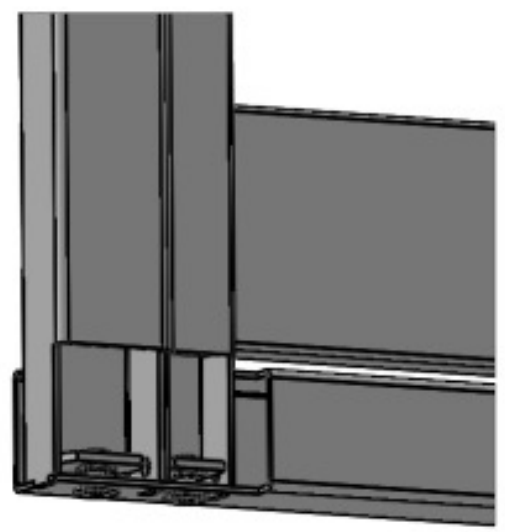
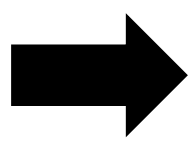
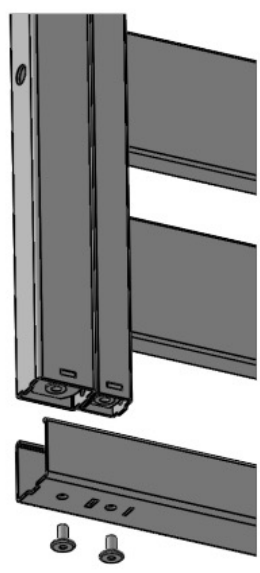

[5]

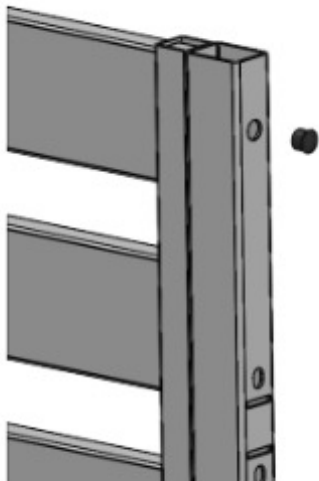

[E]

[6]



[D]

